



INSTALLATION SHEET FOR TS DIRECTIONAL CONTROL VALVES KEEP WITH PRODUCT UNTIL INSTALLED

ADDITIONAL SHEETS MAY BE PRINTED OUT FROM OUR WEBSITE WWW.BRAND-HYD.COM UNDER PRODUCT CATALOG SECTION

How do I adjust pressure relief?

First, loosen the 1" hex lock nut. This gives you access to the relief set screw (5/16" hex). Clockwise rotation of the screw will increase the relief pressure.

What pressure ranges does my relief work in?

If your valve's model tag code ends with a "B", then you have a relief. Normal factory setting for the relief is 1500psi. If there is a 2 digit number behind the "B", then your valve was preset at the factory to that value times 100. For example, the number 30 on the model would indicate a factory relief setting of 3,000psi.

The best pressure ranges for your TS valve will depend on the spring that has been assembled in the relief, if your spring is:

- White (p/n: P1279): 2400 - 3000psi
- Yellow (p/n: P1270): 1400 - 2500psi
- Orange (p/n: P1270-360): 700 - 1400psi
- Yellow (p/n: DC7594): 300 - 700psi

Can I paint my valve? – Painting valves is okay as long as the following precautions are taken: 1- All ports must be plugged and 2- the spool must be masked or taped off completely. Any paint on the spool will cause leakage when it chips off. Warranty is void if any valve is returned with paint on the spool.

How do I assemble the handle to the valve?

Regardless of handle style, the handle retainer will already be installed on the valve.

For the L-style handle, the mounting point of the handle retainer is above the spool.

For the J-style handle (standard), the mounting point of the handle retainer is below the spool.

To install the handle(s):

1. First, align the 2 handle linkage brackets so they taper toward each other. When pressed together they will resemble a "Y".
2. Second, using the longest clevis pin, mount the linkage brackets at their widest point to the outside of the handle retainer. Secure the linkages with 1 of the hitch pins.
Note: For TS3 models, the handle linkages for all 3 spools will be assembled at the factory.
3. Third, using the shortest clevis pin, mount the handle between the linkages using the hole closest to the edge of the handle. Secure the handle with 1 of the remaining hitch pins.
4. Finally, using the remaining clevis pin & hitch pin, secure the handle to spool using the slot in the spool.
5. Repeat 1-4 for 2 spool models.
Refer to drawing for more information.

Note: Unless specified, the retainer's placement is defaulted so the handle points up when the valve is placed on a flat surface. To change this, prior to handle installation, the screws holding the retainer must be removed and the retainer can then be rotated around the valve 180°.

Mounting Surface – The valve must be mounted on a flat surface. It is important not to bend or twist the casting when mounting because this may cause the valve to bind.

All TS's are built with Iosso plated spools to help prevent the spools from locking up when they are in a corrosive environment. For highly corrosive environments, i.e. marine applications, we recommend using a stainless steel spool. To order a valve with a stainless steel spool simply add "SS" to the end of the model code.

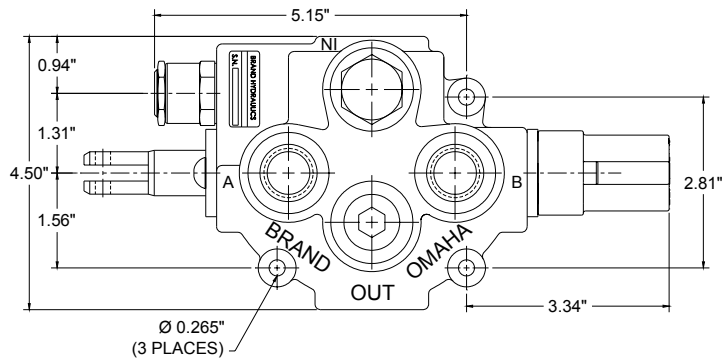
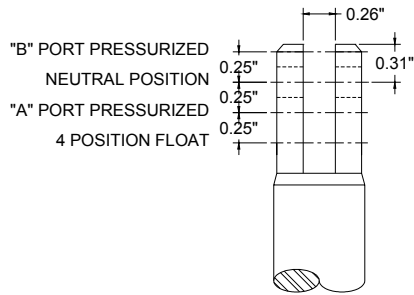

TS1120TF1JB

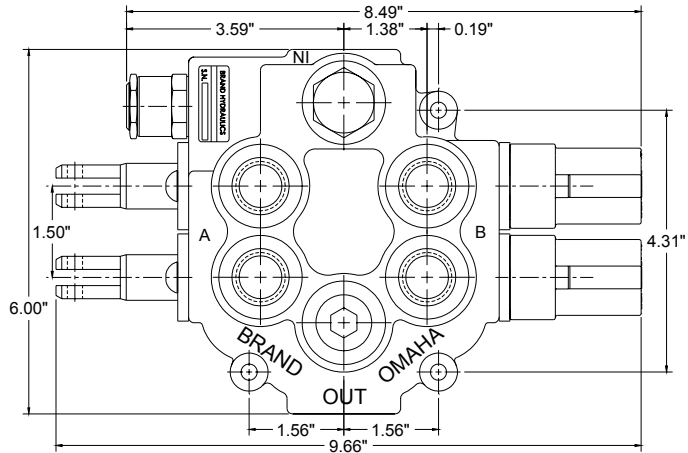
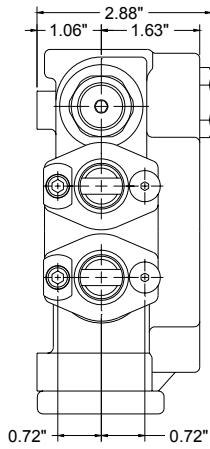

TS2120TF1TSJB

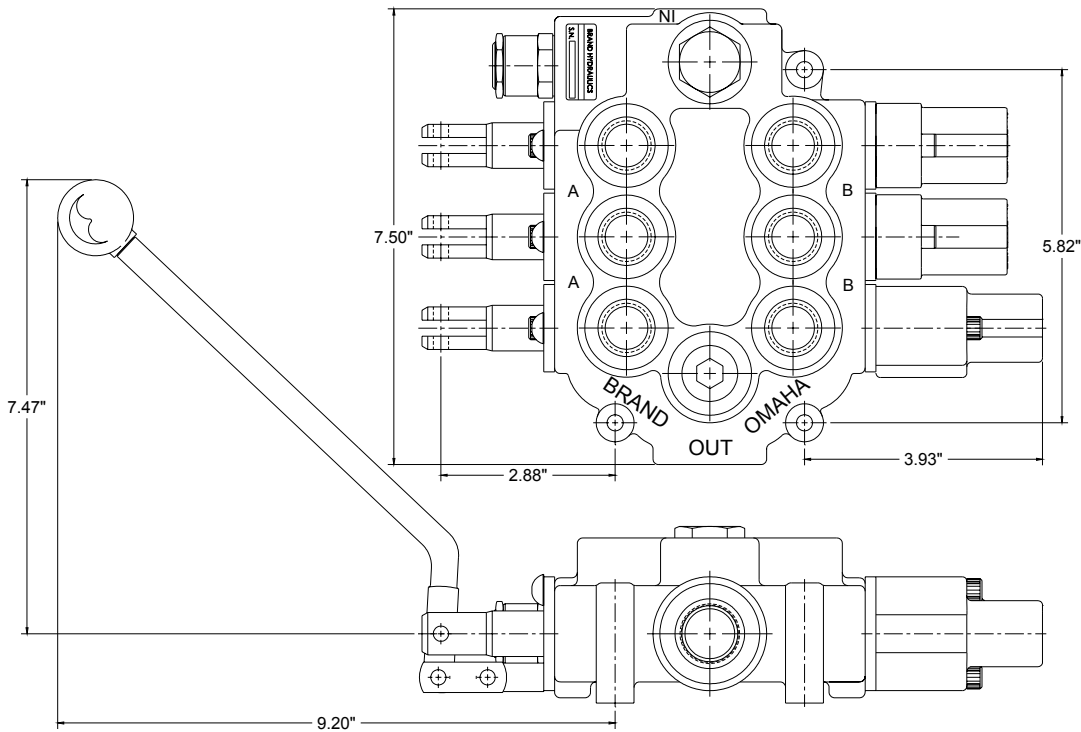

TS3120TSDTSTKJB

Figure 1: Dimensions for TS valves, J-style handle shown in standard position