

## NON-ADJUSTABLE CONSTANT VOLUME PRIORITY DIVIDER “BG4”

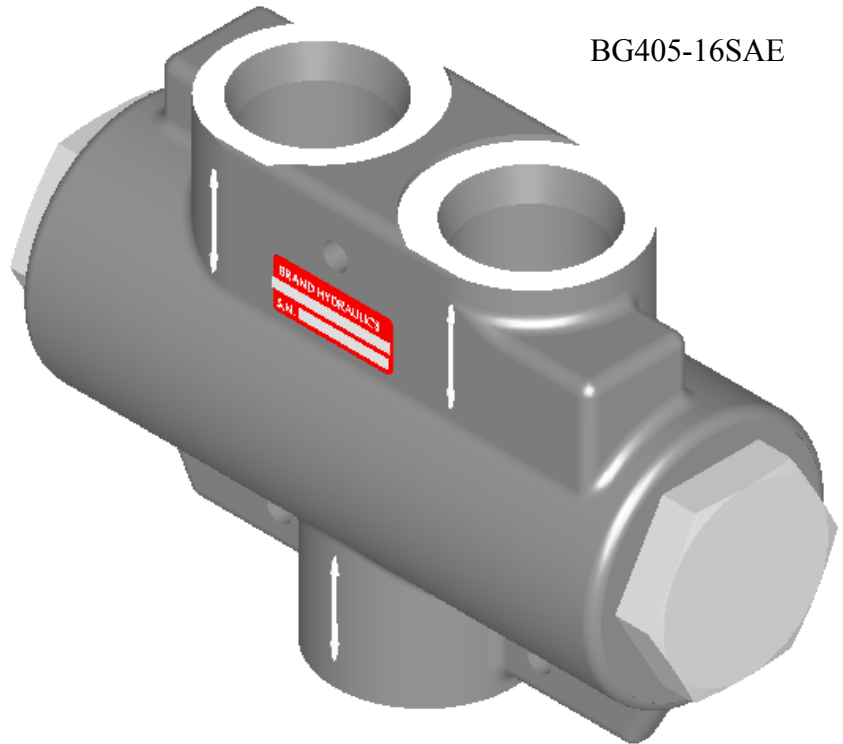
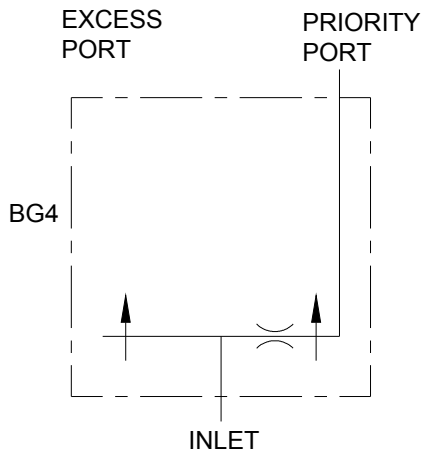

### **FEATURES:**

- **P**RECISION **G**ROUND **H**EAT **T**REATED **S**POOL that assures long life.
- **P**RESSURE **C**OMPENSATION for both outlet ports.
- **P**RIOITY **F**LOW IS **P**RESET at factory to customer requirements.
- **E**VERY **BG4** IS **T**ESTED for priority flow and pressure compensation.
- **L**ARGE **M**ETERING **S**POOL provides a greater area for the pressure differential to act upon.

### **SPECIFICATIONS:**

- **Rated for 3000 psi (207 bar).**
- **Rated for 30-45 gpm (114-170 lpm).**
- **30-Micron filtration recommended.**
- **Weight 8.5 lbs. (3.9 kg).**
- **Standard port size.**
  - **#16SAE (1-5/16-12) all ports.**

### **MATERIALS:**

- **High Strength Cast Iron Body**
- **Buna N O'Rings**
- **Heat Treated Steel Spools**

**BG4 – GENERAL INFORMATION:**

The Brand, BG4 non-adjustable priority flow divider receives a single stream of fluid and divides it into a priority stream and an excess stream. The priority flow port maintains the same flow even with an increase or decrease in the input flow. Both outlet flows are pressure compensating and the sum of said flows equals the inlet flow. Flow can only pass through the valve in one direction, inlet to outlet. Accuracy is normally better than ± 5%. The priority flow setting must be specified when ordering. Pressure drop through the valve will range from 33 to 50 psi (2.3 to 3.4 bar) depending on the flow and pressure in the system.

**BG4 – EXAMPLES OF COMMON MODEL CODES:**

**BG410-16SAE**.....Ten gpm priority (37.8 lpm) setting and #16SAE all ports.

**BG4 – CREATING A MODEL CODE FOR BG4’S:**

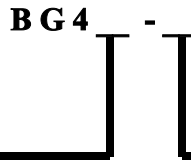

FLOW SETTING:

- 01 – 1 gpm (3.8 lpm) priority flow
- 05 – 5 gpm (18.9 lpm) priority flow
- ETC.

PORT SIZES:

16SAE - #16SAE (1-5/16-12) all ports.

**DIMENSIONAL DATA (BG4 SHOWN): inches & [millimeters]**

